



SUNNYSIDE PLAZA

1820 - 1902 W. COURT ST. JANESVILLE, WI 53548



ONE SPACE LEFT!

FOR RENT | RETAIL

ONE SPACE LEFT WITH 2 ADA RESTROOMS AND DROP DOWN CEILINGS—SAVE BUILD OUT COSTS! LOCATED AT A CVS AND FAMILY DOLLAR CO-ANCHORED PLAZA ON WEST COURT STREET AMONG SOME OF JANESVILLE'S NEWEST RETAIL DEVELOPMENT. AMPLE PARKING FOR YOUR CUSTOMERS AND GREAT VISIBILITY FOR YOUR BUSINESS!

- SPACE AVAILABLE** | 2,100 - 15,570 SF
- ANNUAL NET RENT*** | \$8 / SF
- CAM & TAX** | \$2.85 / SF
- POPULATION** | 65,000+ WITHIN 5 MILES
- AVERAGE HH INCOME** | \$60,000+ WITHIN 5 MILES
- TRAFFIC** | 15,000 VEHICLES PER DAY

*Available spaces only

TENANTS INCLUDE



CONTACT

JAMES MATANKY
312-337-1001 ext. 2015
jmatanky@matanky.com

ARNIE BLAKE
312-337-1001 ext. 2030
ablake@matanky.com

SUNNYSIDE PLAZA

1820 - 1902 WEST COURT STREET, JANESVILLE, WISCONSIN 53548

SITE PLAN

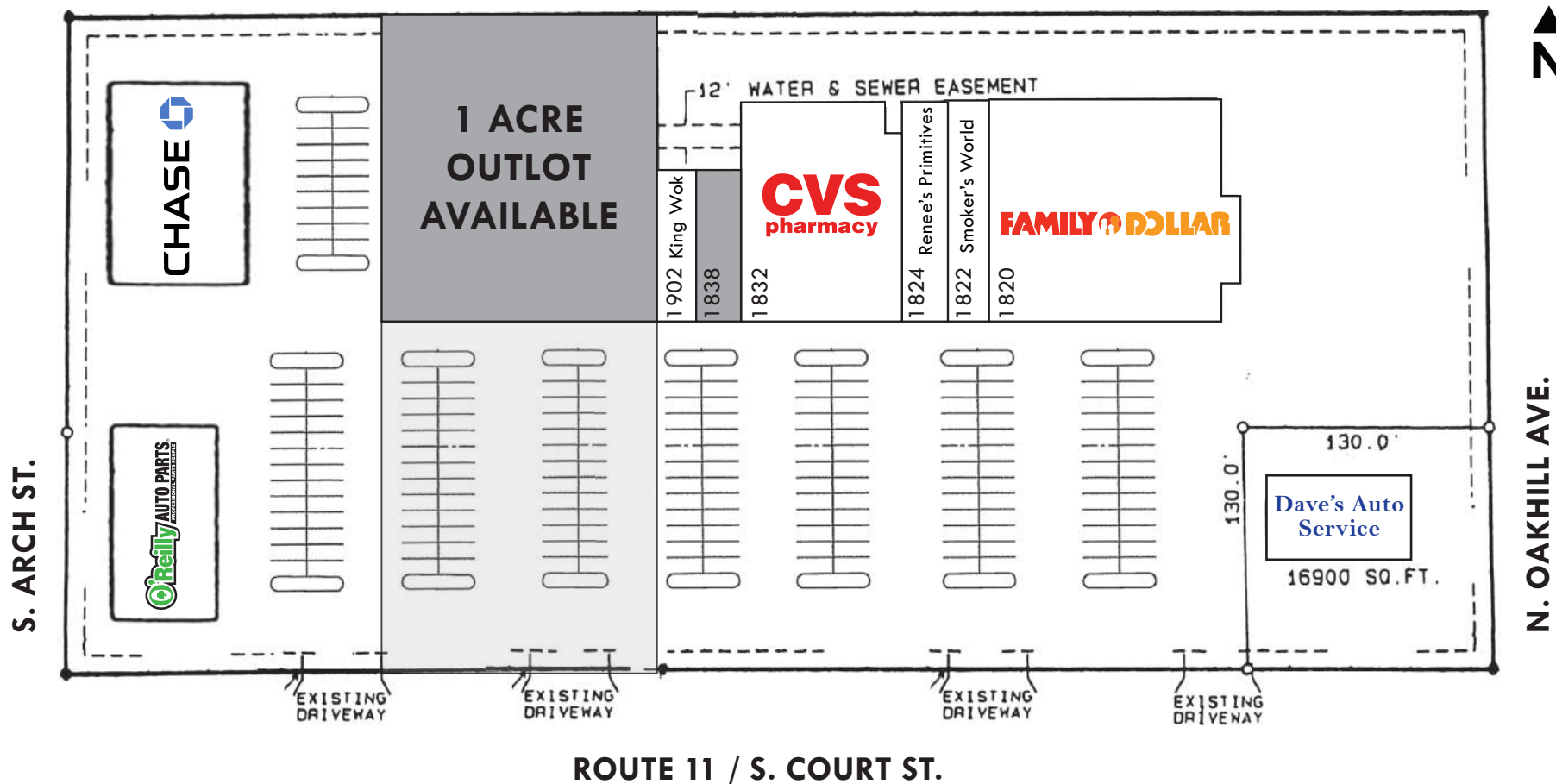

MAP



TENANTS

#	SF	TENANT
1820	12,428	Family Dollar
1822	2,415	Smoker's World
1824	3,702	Renee's Primitives
1832	9,768	CVS
1838	2,100	AVAILABLE
1902	1,600	King Wok

AERIAL

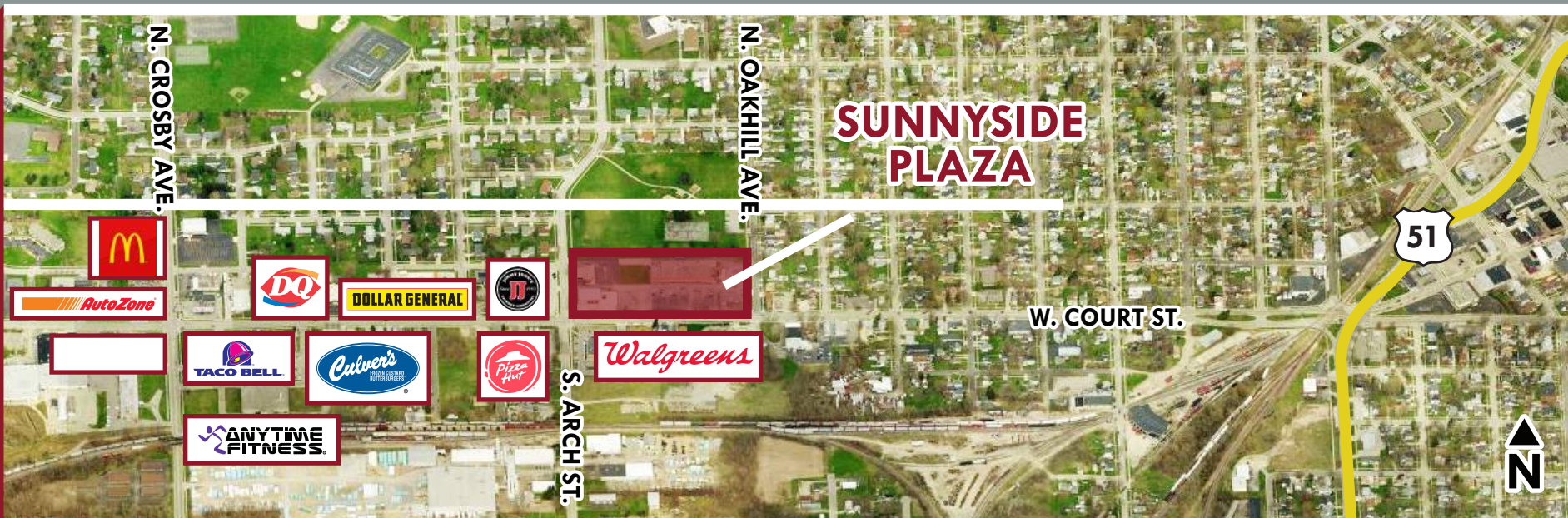

312-337-1001



JAMES MATANKY | ARNIE BLAKE

JOIN US ON:



MATANKY REALTY GROUP

WWW.MATANKY.COM